



18

Eclaté des pièces détachées

Illustrated Part Guide - Explosionszeichnung

HOBIE 18' PACIFIC

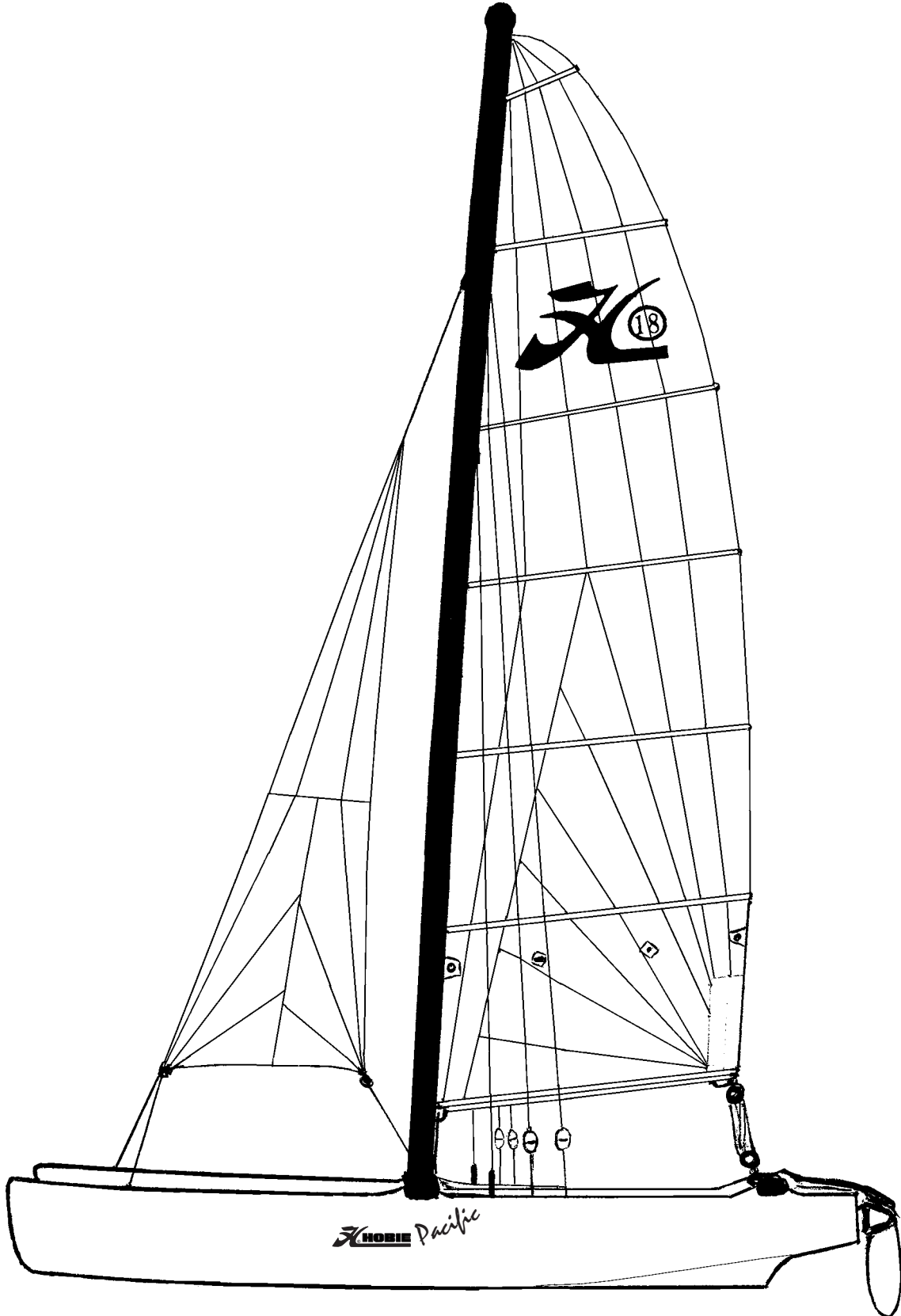

18556010 : Coque gauche
Left hull
Rumpf links

Hobie Cat 18 Pacific
Coque/Hull/Rumpf

18556015 : Coque droite
Right hull
Rumpf rechts

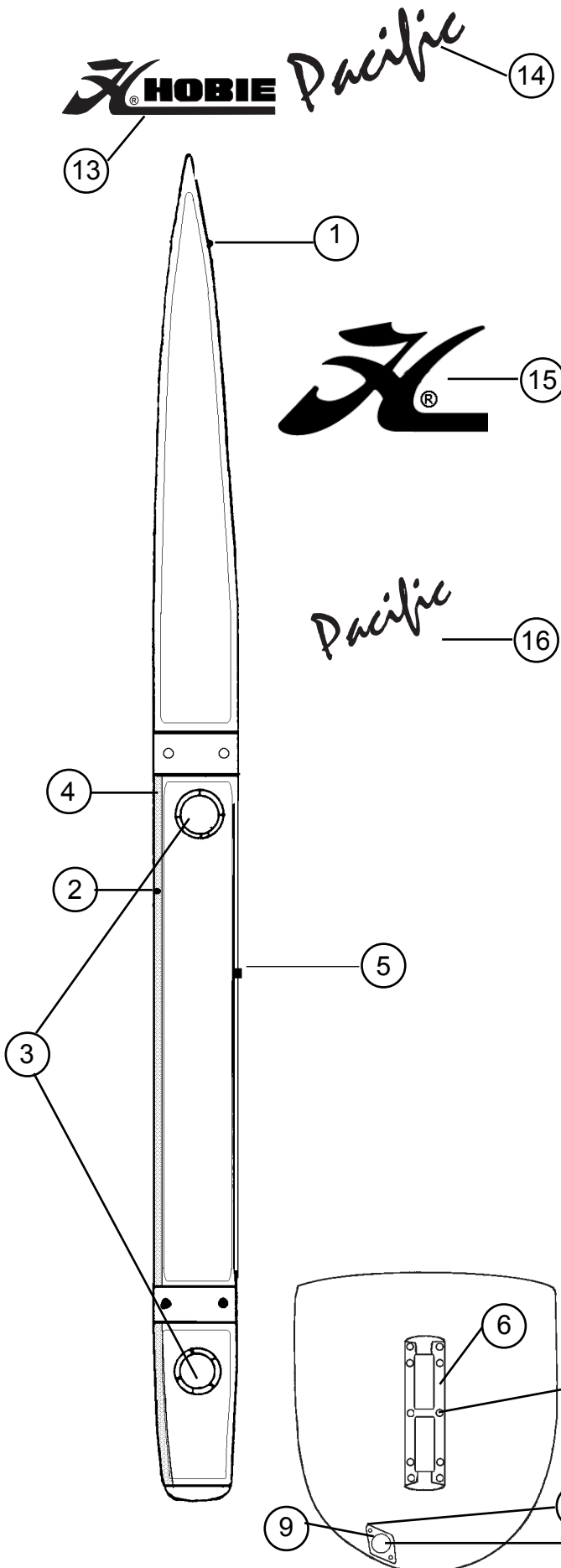

1 - 21060307 :	Platine de bride Bow plate Hahnpot Platte
2 - 21056028 :	Vis cadène Anchor pin Schraube für Püttingeisen
3 - 18056033 :	Trappe de visite Inspection port Lukendeckel
4 - 99506096 :	Antidérapant noir Black anti-skid Antirutschbelag schwarz
5 - 99220215 :	Pontet Eye strap Bügel
6 - 18056005 :	Fémelot Gudgeon Heckbeschlag
7 - 99226001 :	Vis TC fémelot Screw TC gudgeon Schraube TC Heckbeschlag
8 - 99220074 :	Vis TF Bouchon Screw TF plug Ablaßplatte-Schraube
9 - 99056012 :	Platine bouchon vidange Drain housing Platine f. Ablaßschraube
10 - 99220041 :	Joint bouchon vidange Drain plug gasket Dichtung Ablaßschraube
11 - 99220040 :	Bouchon vidange Drain plug Ablaßschraube
12 - 99220043 :	Joint + bouchon (x10) Gasket + drain plug Dichtung + Ablaßschraube
13 - 99056190 :	Autocollant coques H + Hobie bleu Hull sticker H + Hobie blue Rumpf-Aufkleber H + Hobie blau
14 - 99056185 :	Autocollant Pacific bleu Hull sticker Pacific blue Rumpf-Aufkleber Pacific blau
15 - 99056195 :	Autocollant coques H petit Hull stickers H small Rumpf-Aufkleber H klein
16 - 99056180 :	Autocollant Pacific bleu petit Hull sticker Pacific blue small Rumpf-Aufkleber Pacific blau klein

Gouvernail droit complet/Rudder assy right complet
Ruderanlage komplett rechts :
18562105 :

Gouvernail gauche complet/Rudder assy compl. left
Ruderanlage komplett links :
18562100 :

Hobie Cat 18 Pacific Safran/Rudder/Ruderblatt

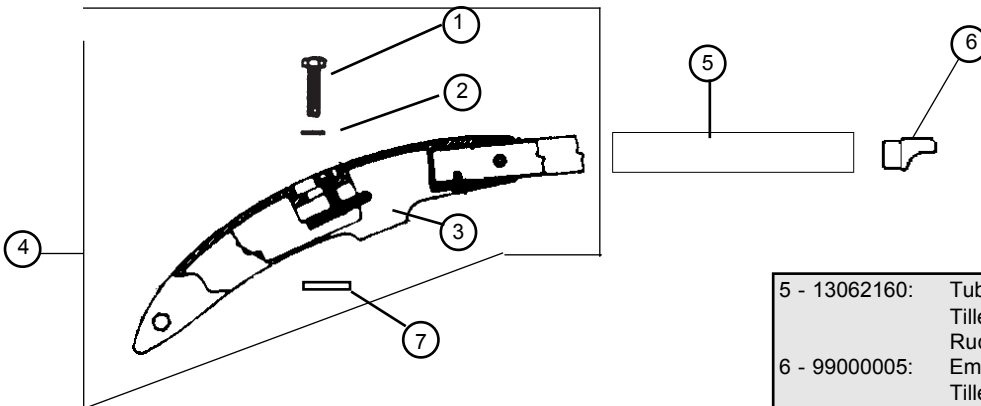

- | | |
|---------------|--|
| 1 - 99221123: | Vis TH 8x30 casting
Cast.bolt
Schraube Gußt. |
| 2 - 99061110: | Rondelle plate
Washer
Unterlegscheibe |
| 3 - 17000010: | Casting supérieur Gouv.
Upper rudder casting
Oberes Rudergehäuse |
| 4 - 18562148: | Bras gouv.droit complet
Tiller arm right complete
Ruderarm rechts komplett |
| 18562147: | Bras gouv.gauche complet
Tiller arm left complete
Ruderarm links komplett |

- | | |
|---------------|---|
| 5 - 13062160: | Tube de Gouvernail
Tiller tube
Ruderrohr |
| 6 - 99000005: | Embout à rotule
Tiller end cap
Pinnenendstück |
| 7 - 14061122: | Platine dural
Cam stop plate
Platine f. oberes Rudergehäuse |
| 8 - 14061180: | Came safran
Plastic cam
Rudernock |
| 9 - 16041755: | Goupille élastique
Maststep pin
Sprengbolzen |
| 10- 99502175: | Lame safran White Knight
Ruder blade
Ruderblatt |
| 11- 99220003: | Vis safran 8x60
99220066 (X50)
Rudder bolt
Schraube Ruderblatt |

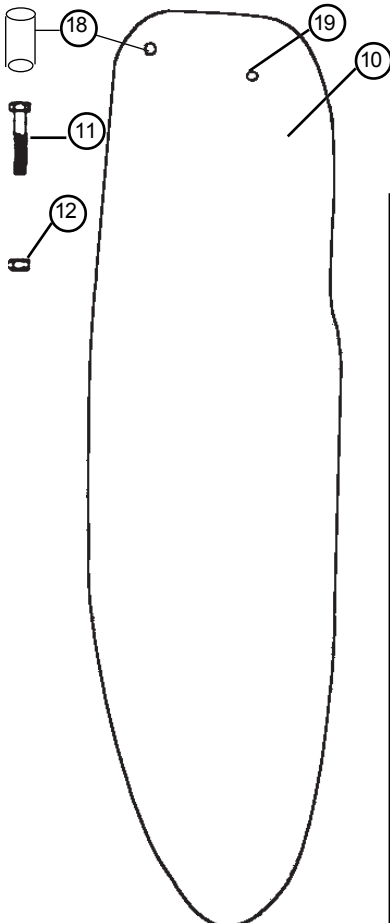

- | | |
|---------------------|---|
| 12- 99220012: | Ecrou Nylstop
99220079 (x20) Nylstop nut
99220080 (x50) Selbstsichernde Mutter |
| 13- 18000155: | Casting inf. gouv
Lower rudder casting
Unteres Rudergehäuse |
| 14- 21080335 (inox) | Aiguillot + goupille
Rudder pin + cotter pin
Ruderbolzen + Splint |
| 15- 14061105: | Pene safran
Plunger
Gegenstück Rudernock |
| 16- 99220004: | Ressort inox
Spring
Feder |
| 17- 99220006: | Vis safran delrin
Tension screw
Druckschraube |
| 18- 99502130: | Insert lame safran
Sheave pin rudder blade
Bolzen Ruderblatt |
| 19- 14041711: | Axe tête de mât
Mast head axle
Mastkopf Achse |
| 20- 17062680 : | Casting inférieur monté
Lower rudder cast.assembled
Unteres Rudergehäuse montiert |

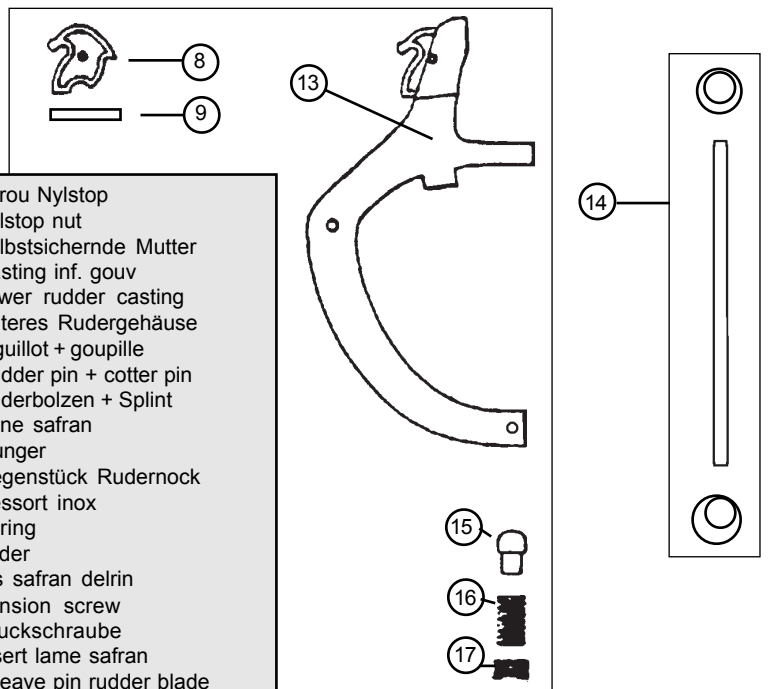

Hobie Cat 18 Pacific

Étai & drisse de foc/Forestay and jib halyard Vorstag und Fockfall

- 1 - 18560510 : Étai câble sans pivot
Forestay wire w/o swivel
Vorstagkabel o. Wirbel
- 2 - 18060590 : Pivot étau de foc
Forestay swivel
Fockvorstagwirbel
- 3 - 18560535 : Estrope + emerillon
Complete pigtail + swivel
Pigtail komplett mit Wirbel

- 7 - 18080100 : Poulie étauq. drisse de foc
Jib halyard block
Fockfallblock

- 4 - 18060540 : Poulie drisse de foc
Jib halyard block assy
Fockfallumlenk-Block
- 5 - 18060555 : Drisse câble de foc
Jib halyard wire
Fockfall Kabel
- 6 - 99220036 : Manille lyre 4 mm
Shackle 4 mm
Schäkel 4 mm

- 8 - 21060150 : Enrouleur de foc
Jib furler
Fockwickler
- 9 - 18061580 : Bride
Bridle
Hahnepot

- 10 - 99220034 : Axe percé latte ridoire
99220081 (x50) Clevis pin
Bolzen f. Locheisen geb.
- 11 - 99220230 (x10) : Anneau brisé
99220131 (x50) Split ring
Ringsplint

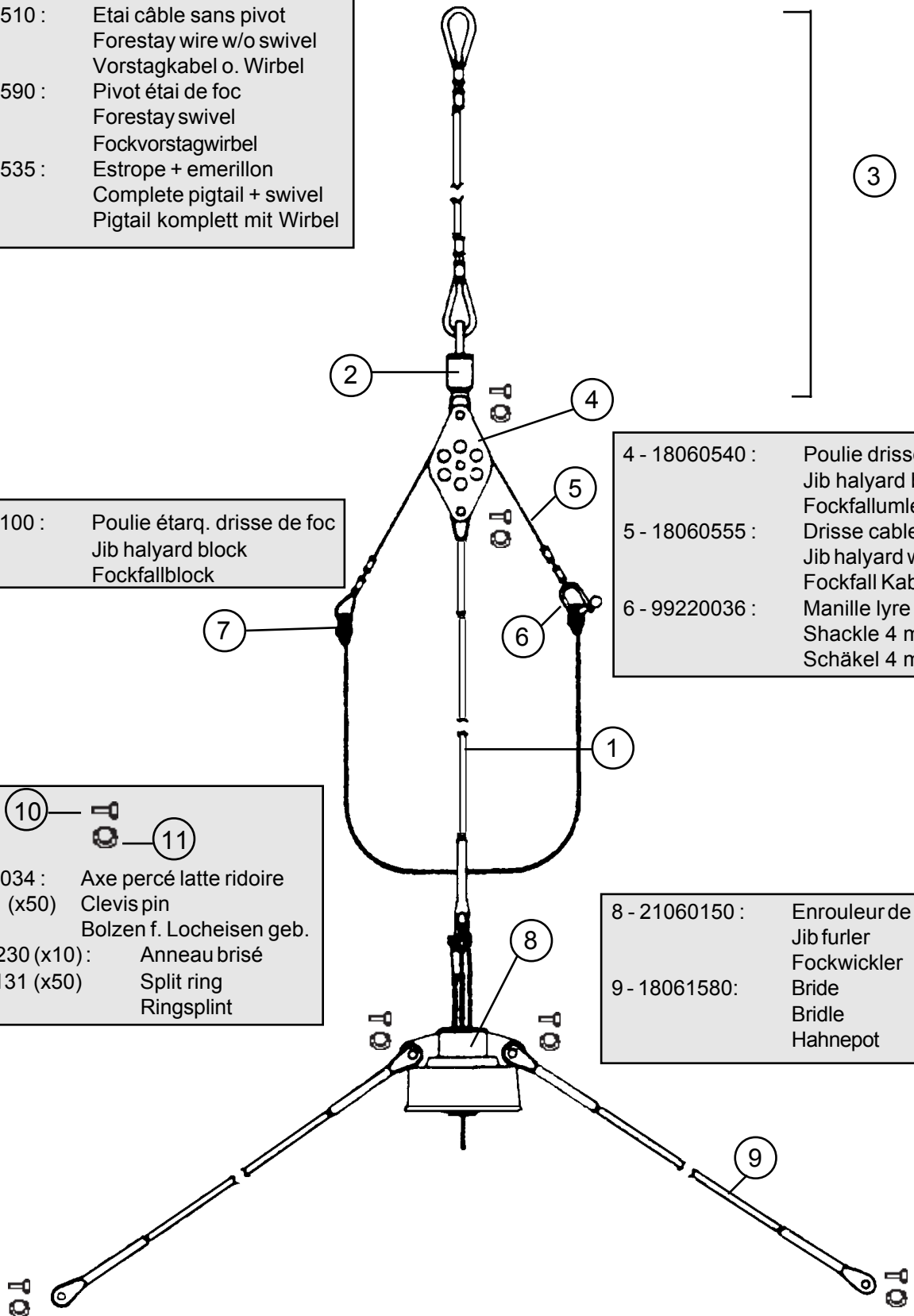

Hobie Cat 18 Pacific

Trapèze/Trapeze/Trapez

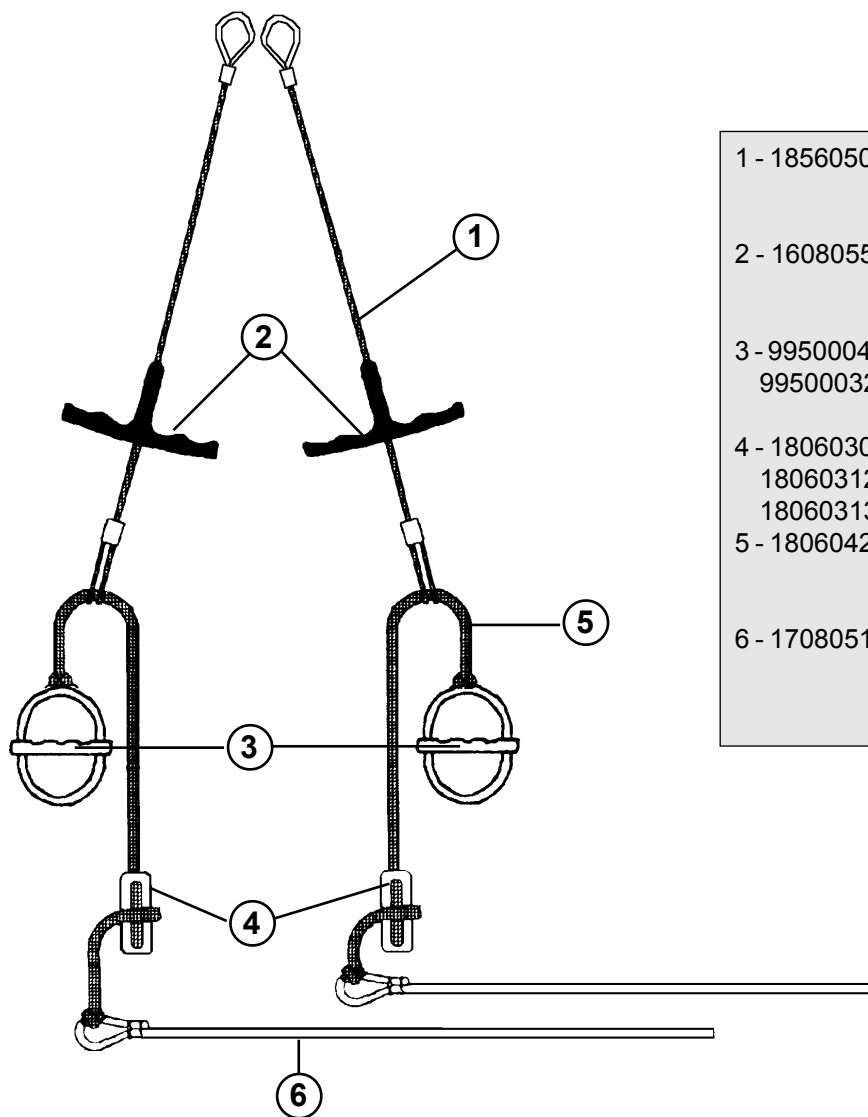

- | | |
|--|--|
| 1 - 18560505 : | Cable trapèze gainé
Coated trapeze wire
Trapezkabel überzogen |
| 2 - 16080552 : | Poignée de trapèze
Trapeze handle
Trapezgriff |
| 3 - 99500040 (x2)
99500032 (x20) | Poignée J&H
J&H handle
J&H Trapezgriff |
| 4 - 18060301 :
18060312 (x20)
18060313 (x40) | Double anneau réglage trap.
Rope lock trapeze
Trapezschotstopper |
| 5 - 18060420 : | Cordage D5 réglage trap.
Trapeze line D5
Trapezleine D5 |
| 6 - 17080511 : | Sandow trapèze
Trapeze sandow
Gummistrop |

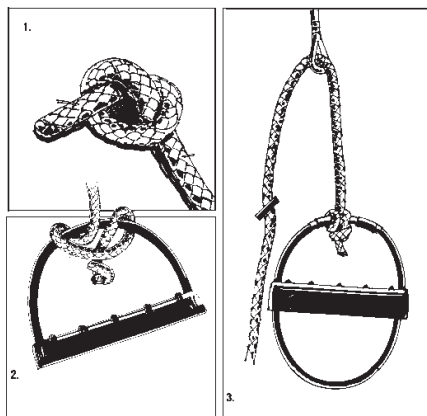

Montage des poignées de trapèze Instruction for connecting your trapeze handle Wie man die Trapezgriffe knotet

- Faire un noeud à la fin du cordage 6 mm
Tie knot firmly at end of 6 mm
Fester Knoten am Ende der Leine
- Fixer fermement la corde nouée à la poignée comme indiqué sur le dessin en s'assurant que la corde ne puisse pas glisser du milieu de la poignée.
Fix knotted rope firmly to handle as illustrated, ensuring that rope cannot move from top centre of handle.
Webleinensteck wie gezeigt fest anziehen
- Attacher normalement la corde au câble de trapèze.
Attach rope and handle to trapeze wire as normal.
Leine durch Trapezkausch und wie üblich befestigen

Hobie Cat 18 Pacific Haubans/Shrouds/Wanten

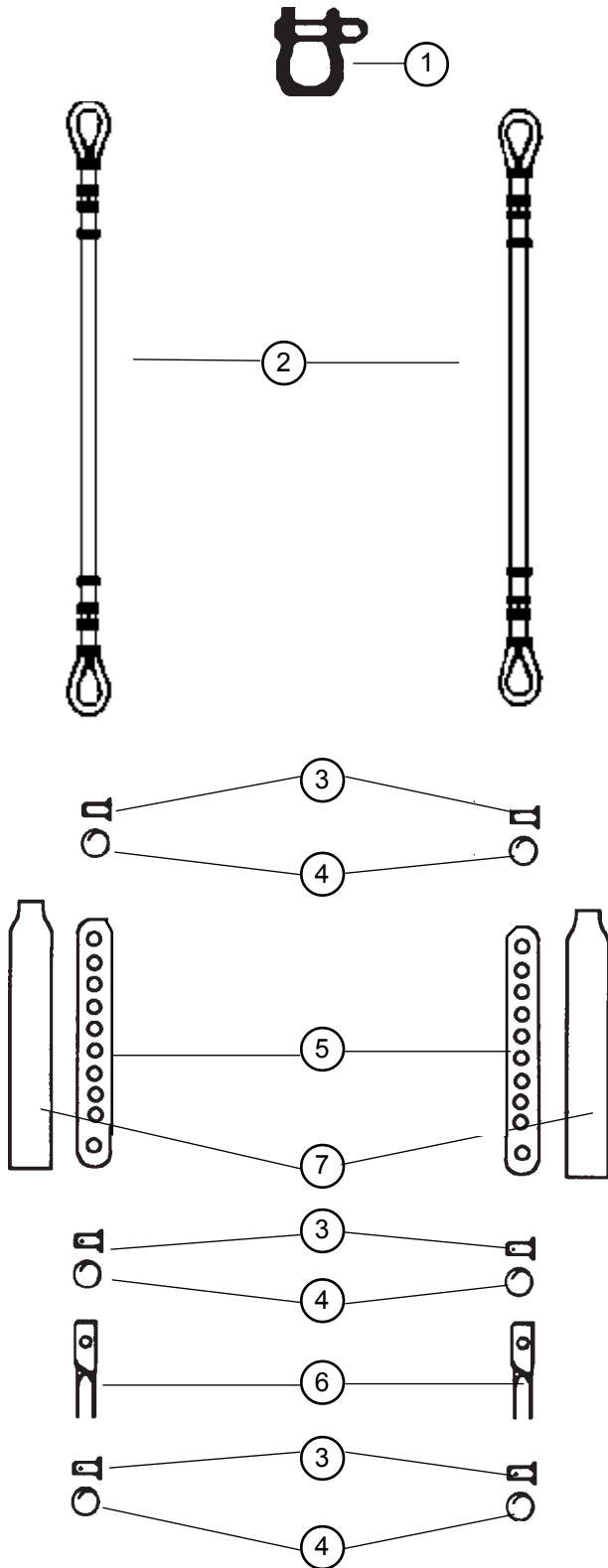

1-	99220058: 99220210 (x10)	Manille Lyre 8 mm Bow shackle Mastschäkel
2-	18560500:	Hauban Shroud Want
3-	99220034: 99220081 (x50)	Axe percé lat.ridoir Clevis pin Bolzen für Wanteisen
4-	99220230 (x10) 99220131 (x50)	Anneau brisé Split ring Ringsplint
5-	99220033:	Latte ridoir Stay adjuster Wantenspanner
6-	16060312:	Chape de hauban Toggle Wanten Wirbel
7-	99500360: 99500363 (x2) 99500364 (x20)	Protège latte ridoire Shroud adjuster cover Wantenschutz

Hobie Cat 18 Pacific
 Traverse avant/Front crossbar/Vorderholm
 18562500 (2,50 m)
 18062539 (2,60 m)

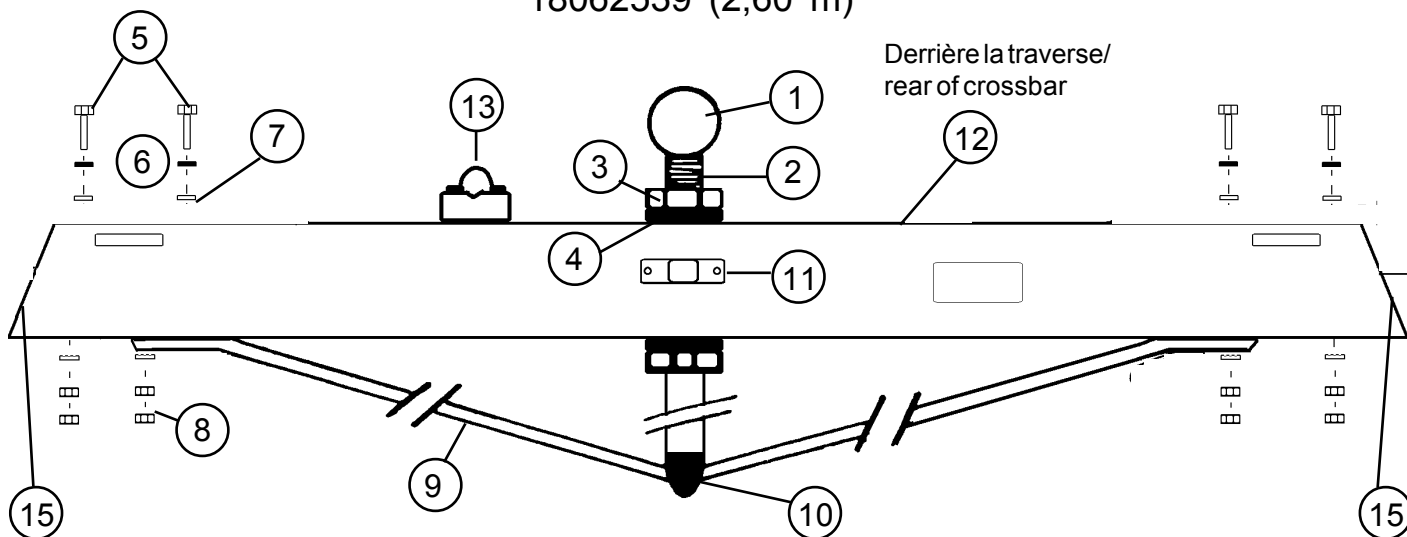

- | | |
|----------------|---|
| 1 - 21062673 : | Emplanture de mât
Mast step ball
Mastfußkugel |
| 2 - 18062680 : | Étai de martingale
Dolphin striker post
Unterzug gebohrt |
| 3 - 99220104 : | Ecrou HU D16
Nut HU D16
Mutter HU D16 |
| 4 - 99220100 : | Rondelle D16
Washer D16
Unterlegscheibe D16 |
| 5 - 99220335 : | Vis TH 10 x 150 x 50
Screw TH
Schraube TH |
| 6 - 99220059 : | Rondelle D10
Washer D10
Unterlegscheibe D10 |
| 7 - 99220260 : | Rondelle D10.2 nylon
Nylon washer D10.2
Nylon Unterlegscheibe D10.2 |
| 8 - 99220009 : | Ecrou HU D10
Nut HU D10
Mutter HU D10 |

- | | |
|-----------------|---|
| 9 - 18562700 : | Martingale HC18Ti
Dolphinstriker HC18Ti
Unterzug HC18Ti |
| 10 - 21000010 : | Support étau de martingale
striker bar fastening
Unterzug Fuß |
| 11 - 16056025 : | Articulation inox tangon
Spi pole articulation inox
Verbindung Spibaum inox |
| 12 - 99500415 : | Taquet enrouleur
Furler cleat
Wicklerklemme |
| 13 - 99500350 : | Tourelle Taquet
Swivel Camcleat
Drehklemme |
| 18580060 : | Glissière de foc droite
Fock swivel cleat slider right
Fockdrehklemmegleit rechts |
| 18580055 : | Glissière de foc gauche
Fock swivel cleat slider left
Fockdrehklemmegleit links |
| 14 - 18062415 : | Bouchon traverse droit
Beam cap right
Vorderholmendstück rechts |
| 15 - 18062410 : | Bouchon traverse gauche
Beam cap left
Vorderholmendstück links |

Hobie Cat 18 Pacific
 Traverse arrière/Rear crossbar
 Achterholm
 18562570 (2,50 m)
 18562580 (2,60 m)

- | | |
|----------------|---|
| 1 - 99220335 : | Vis TH 10 x 150 x 50
Crossbar bolt
Holmbolzen |
| 2 - 99220059 : | Rondelle D10
Washer D10
Unterlegscheibe D10 |
| 3 - 99220260 : | Rondelle D10.2 nylon
Nylon washer D10.2
Nylon Unterlegscheibe D10.2 |
| 4 - 99220009 : | Ecrou HU D10
Nut HU D10
Mutter HU D10 |
| 5 - 18062405 : | Bouchon traverse AR droit
Beam end cap rear right
Achterholmendstück hint. rechts |
| 6 - 18062400 : | Bouchon traverse AR gauche
Beam end cap rear left
Achterholmendstück hint. links |

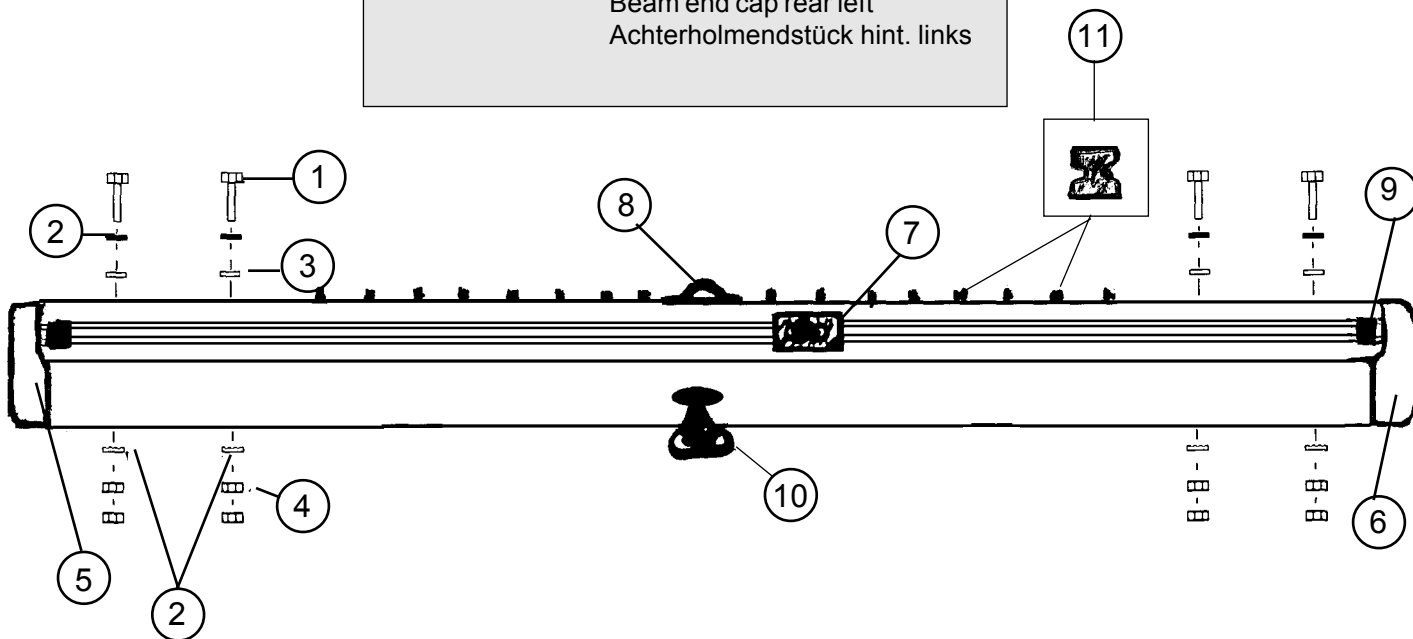

- | | |
|----------------|---|
| 7 - 99500255 : | Chariot de grand-voile
Traveller car
Großtraveller |
| 8 - 99220057 : | Pontet forgé D5
Eye strap
Guseisenbeschlag |
| 9 - 21062521 : | Embout rail d'écoute grand voile
Traveller track end stop
Travellerschiene Endstück |

- | | |
|-----------------|--|
| 10 - 99500350 : | Tourelle
Swivel Camcleat
Drehklemme |
| 11 - 99500700 : | Crochet de laçage trampoline
Trampoline lacing post (x16) |

Hobie Cat 18 Pacific
 Barre d'accouplement / Tiller crossbar
 Anlenkstange / 18062260

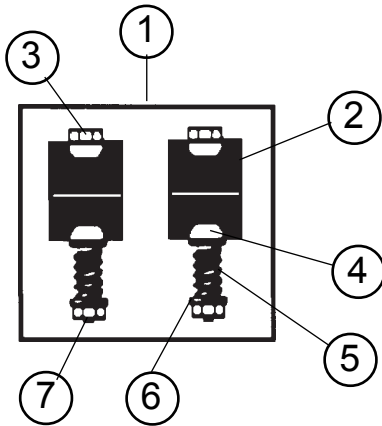

- 1 - 99500380: Kit d'articulation TCM LE
Tiller connector kit LE
Verbindungsgelenk LE
- 2 - 99500331: Demi-pallier
Rubber spacer
Distanzhülse
- 3 - 99220027: Vis TH
TH screw
TH Schraube
- 4 - 99220029: Demi-bille nylon
Half ball nylon
Nylon Halbkugel
- 5 - 99500335: Ressort TCM
TCM spring
TCM Feder

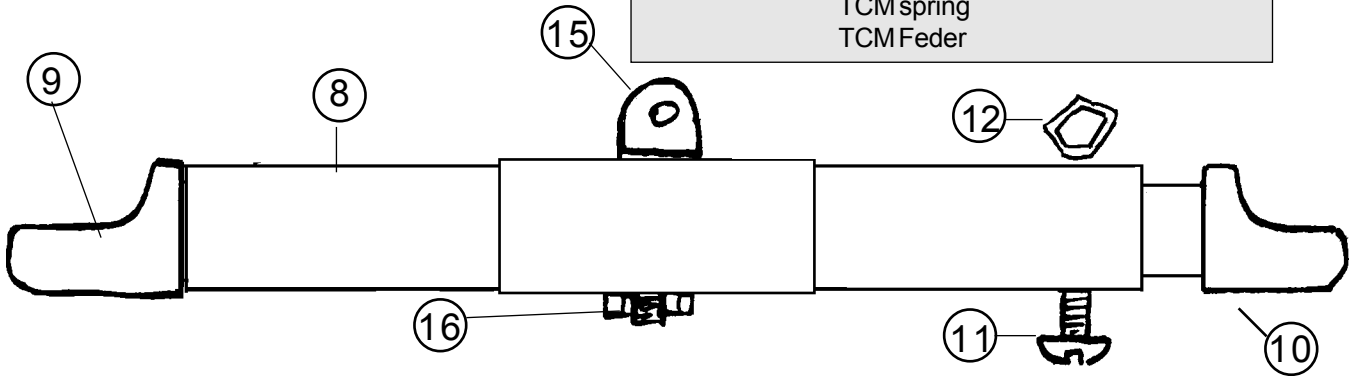

- 6 - 99220032: Rondelle inox
Stainless washer
Unterlegscheibe
- 7 - 99220019: Ecrou indessérable D6
Nylstop nut D6
Selbstsichernde Mutter
- 8 - 18562200 : Barre accoupl.avec renfort
Tiller crossbar with sleeve
Anlenkstange
- 9 - 99061105 : Embout à rotule
Tiller End Cap
Pinnenendstück
- 10 - 99000010 : Coulisseau réglage accplt
Adjustable Tiller
Eingerichtet Gleiter
- 11 - 99220010 : Vis Manillon barre accplt
Shackle screw for Tiller crossbar
Schraube für Anlenkstange
- 12 - 99220011 : Ecrou HUDS barre accplt
Bolt for Tiller crossbar
Mutter für Anlenkstange

- 13 - 14061240 : Axe percé art. Stick
Clevis Pin
Bolzen/Bolzen Pinnengelenk
- 14 - 99220031 : Anneau brisé
9922030 (x10) Split ring
99220131 (x50) Ringsplit
- 15 - 14061320 : Chape articulation stick
Yoke connection
Pinnengelenk
- 16 - 99220012 : Ecrou indessérable
99220079 (x20) Nylstop nut
99220080 (x50) Mutter Nylstop Inox
- 17 - 14061310 : Embout stick fibre
Fibreglas extension tip
Pinnenendstück Fibreglas
- 18 - 18062315 : Stick fibre de verre magnum
Fibreglas tiller extension magnum
Pinnenauslege Fibreglas Magnum

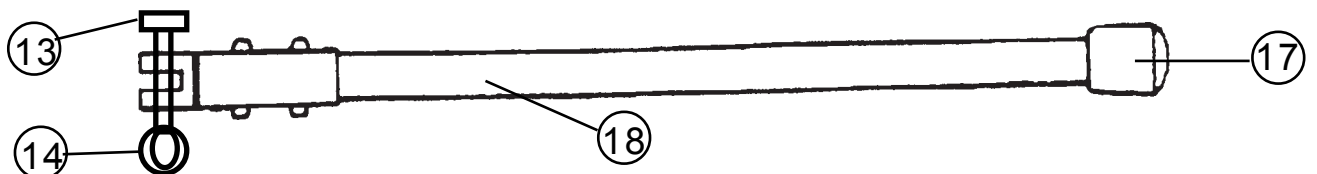

Hobie Cat 18 Pacific

Enrouleur/Jib furler/Fockroller 21060150

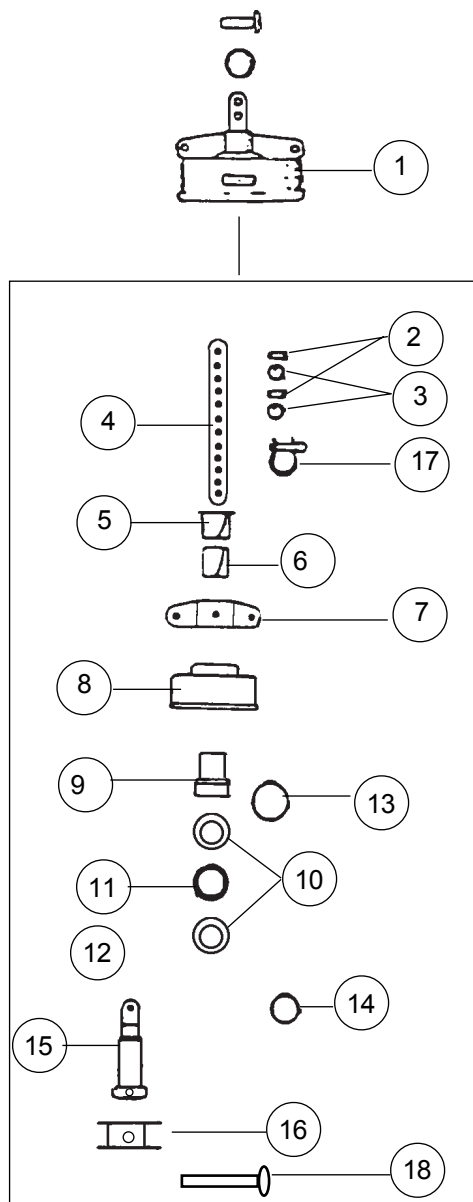

18 - 21060160 : Vis de blocage
Locking screw
Blockierungs-
Schraube

- | | |
|-----------------|--|
| 1 - 21060150 : | Enrouleur
Jib furling assembly
Fockwickler |
| 2 - 99220034 : | Axe percé latte ridoir |
| 99220081 (x50) | Clevis pin
Bolzen für Locheisen |
| 3 - 99220031 : | Anneau brisé |
| 99220131 (x50) | Split ring |
| 99220230 (x10) | Ringsplint |
| 4 - 99220350 : | Latte ridoire enrouleur
Furling stay adjuster
Fockroller-Stagspanner |
| 5 - 21060151 : | Entretoise nylon supérieure
Upper nylon bushing
Obere Nylon Hülse |
| 6 - 21060152 : | Entretoise nylon inférieure
Lower nylon bushing
Untere Nylon Hülse |
| 7 - 21060590 : | Coupleur à brides
Yoke
Hahnepot |
| 8 - 21060153 : | Carter plastic
Plastic furler housing
Wickler-Plastikgehäuse |
| 9 - 21060157 : | Entretoise métal
Sleeve
Metallhülse |
| 10 - 21060158 : | Flasque roulement
Bearing race
Kugellagerseitenwand |
| 11 - 21060154 : | Cage de roulement
Bearing cage
Kugellager Gehäuse |
| 12 - 21060156 : | Bille de roulement
Bearings
Kugellager |
| 13 - 21060305 : | Circlips grand modèle
Darby ring large
Offener Ring groß |
| 14 - 21060306 : | Circlips petit modèle
Darby ring small
Offener Ring klein |
| 15 - 21060313 : | Axe principal
Tube
Hauptachse |
| 16 - 21060155 : | Bobine
Spool
Trommel Fockroller |
| 17 - 99220035 : | Manille 6 mm |
| 99220092 (x20) | Shackle 6 mm |
| 99220093 (x50) | Schäkel 6 mm |

Hobie Cat 18 Pacific

Barre de flèche et cables

Spreaders and diamond wires

Saling und Diamondwant

99064050 : KIT BARRE DE FLECHE cpllt
SPREADER ASSEMBLY
SALINGBAUSATZ

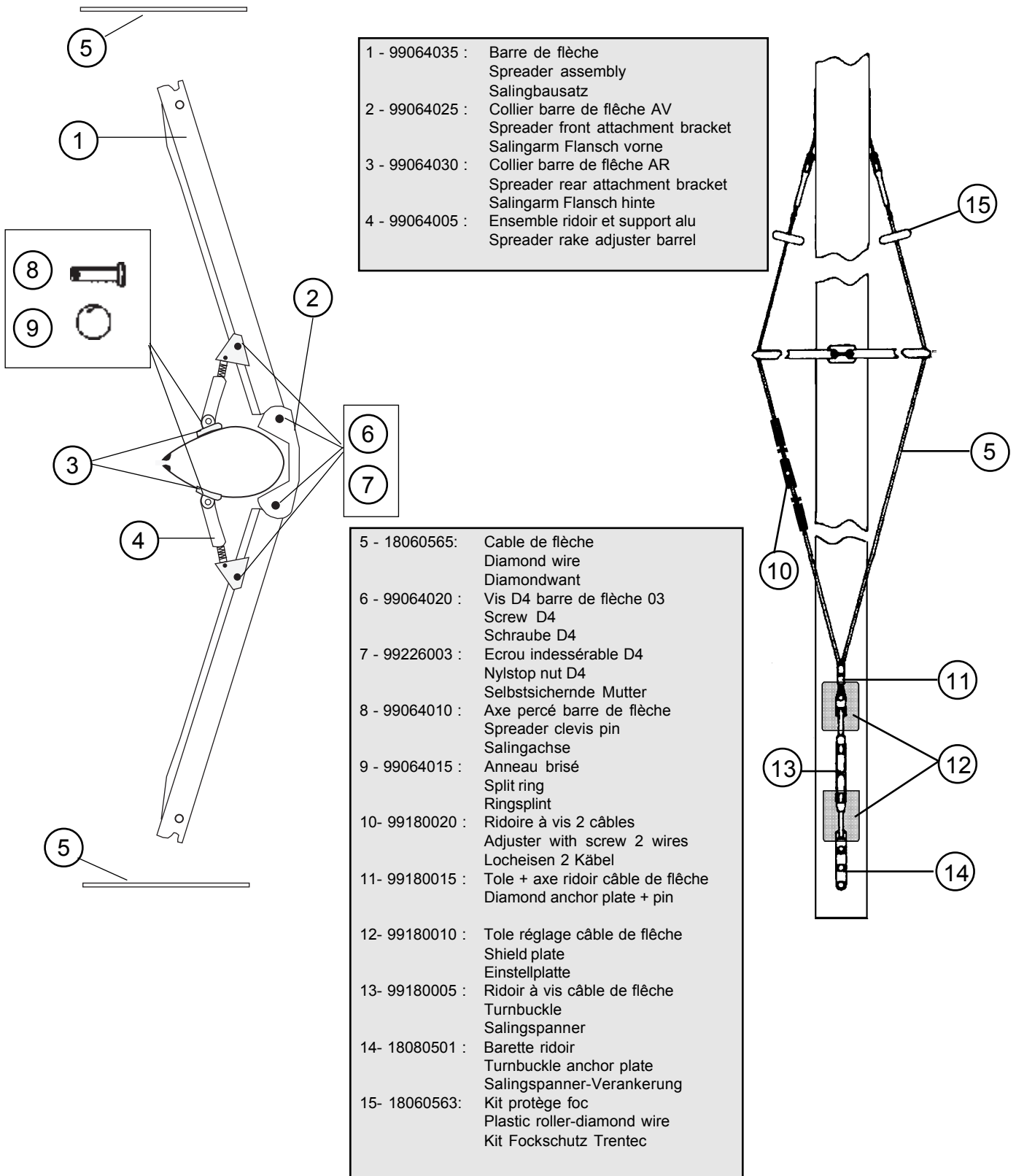

- 1 - 99064035 : Barre de flèche
Spreader assembly
Salingbausatz
- 2 - 99064025 : Collier barre de flèche AV
Spreader front attachment bracket
Salingarm Flansch vorne
- 3 - 99064030 : Collier barre de flèche AR
Spreader rear attachment bracket
Salingarm Flansch hinte
- 4 - 99064005 : Ensemble ridoir et support alu
Spreader rake adjuster barrel

- 5 - 18060565 : Cable de flèche
Diamond wire
Diamondwant
- 6 - 99064020 : Vis D4 barre de flèche 03
Screw D4
Schraube D4
- 7 - 99226003 : Ecrou indessérable D4
Nylstop nut D4
Selbstsichernde Mutter
- 8 - 99064010 : Axe percé barre de flèche
Spreader clevis pin
Salingachse
- 9 - 99064015 : Anneau brisé
Split ring
Ringsplint
- 10- 99180020 : Ridoir à vis 2 câbles
Adjuster with screw 2 wires
Locheisen 2 Kabel
- 11- 99180015 : Tole + axe ridoir câble de flèche
Diamond anchor plate + pin
- 12- 99180010 : Tole réglage câble de flèche
Shield plate
Einstellplatte
- 13- 99180005 : Ridoir à vis câble de flèche
Turnbuckle
Salingspanner
- 14- 18080501 : Barette ridoir
Turnbuckle anchor plate
Salingspanner-Verankerung
- 15- 18060563 : Kit protège foc
Plastic roller-diamond wire
Kit Fockschutz Trentec



18542700 : Mât complet
Complete mast
Mast komplett

Hobie Cat 18 Pacific Mât/Mast/Mast

- 1 - 16000005 : Tête de mât noire
Black mast head
Mastkopf schwarz
- 2 - 16041753 : Sceau de mât
Mast plug
Mast-Abdichtung
- 3 - 18541720 : Crochet de drisse
Halyard hook
Fallhaken
- 4 - 99500114 : Poulie simple Harken
Harken single block
Block Harken einfach
- 5 - 99220235 : Pontet forgé D5
Eye strap
Guseisenbeschlag
- 6 - 18041721 : Collier de spi
Mast tang spi
Mastbeschlag Spi
- 7 - 21041720 : Ferrure de capelage
Mast tang
Mastbeschlag
- 8 - 21080511 : Barrette cable de flèche
Diamond wire holder
Salingdraht-Mastbeschlag
- 9 - 18060333 : Collier barre de flèche AV
Spreader root forward
Saling Ringflansch vorder
- 10 - 18060334 : Collier barre de flèche AR
Spreader root aft
Saling Ringflansch hinten
- 11 - 99220050 : Taquet de drisse
Halyard cleat
Niederholer-Mastklemme
- 12 - 99500351 : Taquet aluminium
Clamcleat aluminium
Klemme aluminium
- 13 - 14041723 : Autocollant de sécurité
Mast caution label
Sicherheitsaufkleber
- 14 - 17041750 : Réa de vit moulet
Gooseneck sheave
Lümmelbeschlag Rolle
- 15 - 99500332 : Vis 6x60
Screw 6x60
Schraube 6x60
- 16 - 99220094 : Vis 6x80
Screw 6x80
Schraube 6x80
- 17 - 99220019 : Ecrou indessérable 6 mm
Nut nylstop 6 mm
Selbstsichernde Mutter 6 mm
- 18 - 17000020 : Base de mât
Mast base
Mastfußpfanne
- 19 - 18080501 : Barrette ridoire câble de flèche
Turnbuckle anchor plate
Salingspanner-Platte
- 20 - 99180010 : Tôle réglable câble de flèche
Bottlescrew shield plate
Salingspanner-Schutzplatte
- 21 - 18541750 : Drisse câble grand-voile
Main halyard wire
Großfall-Kabel

- 22- 18062717 : Plaque compression
Compression sheet
Metalplatte
- 23- 18041780 : Entretoise mat
Mast bushing
Mast Huelse
- 24- 18011865 : Embase vit moulet
Gooseneck base
Maststück f. Lümmelbeschlag

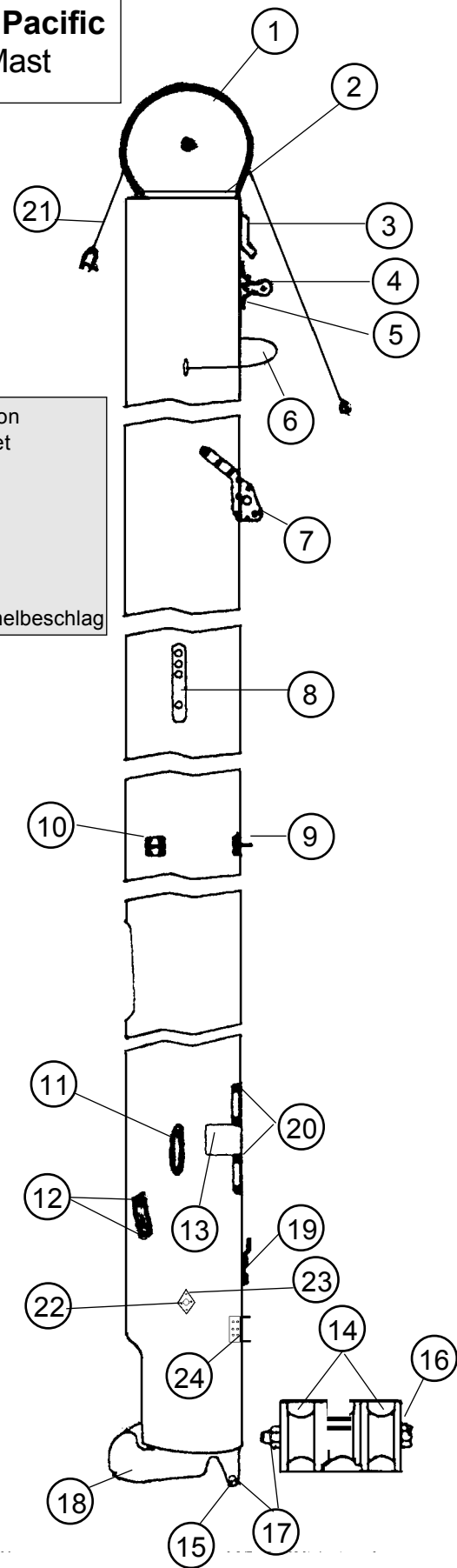

Hobie Cat 18 Pacific
Grand-voile/Main sail/Großsegel

Grand-voile Hobie Cat 18 Pacific
Hobie Cat 18 Pacific main sail
Hobie Cat 18 Pacific Großsege

Blanche/White/Weiss = 18530000
Couleur/Colour/Farbig 2002 = 18530005
Couleur/Colour/Farbig 2003 = 18530006

Grand-voile Hobie Pacific Sport
Hobie Pacific Sport main sail
Hobie Pacific Sport Großsegel

Blanche/White/Weiss 18530030

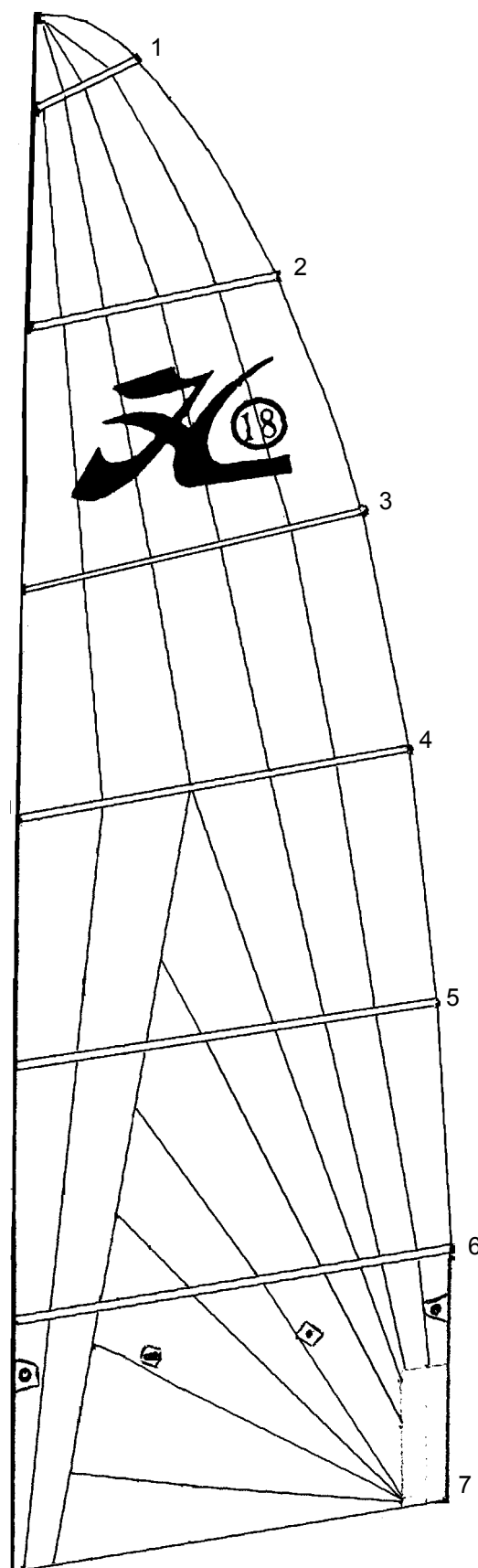

Lattes de grand-voile Hobie Cat 18 Pacific
Hobie Cat 18 Pacific main battens
Hobie Cat 18 Pacific Großsegel-Latten

18534010 : Jeu de lattes de grand-voile complet
Main Batten set complete
Großsegel-Lattensatz kompl.

- #1 : 18534011
- #2 : 18534012
- #3 : 18534013
- #4 : 18534014
- #5 : 18534015
- #6 : 18534016
- #7 : 18534017

Hobie Cat 18 Pacific Foc/Jib/Fock

18530110:	Foc blanc (grand modèle) White jib (large) Fock weiß (groß)
18530115:	Foc couleur (grand modèle) Colour jib (large) Fock farbig (groß)
18530100:	Foc blanc White jib Fock weiß
18530105:	Foc couleur 2002 Colour jib Fock farbig
18530106:	Foc couleur 2003 Colour jib 2003 Fock farbig 2003
18570350:	Accastillage grand foc Rig large jib Ausstattung für großer Fock

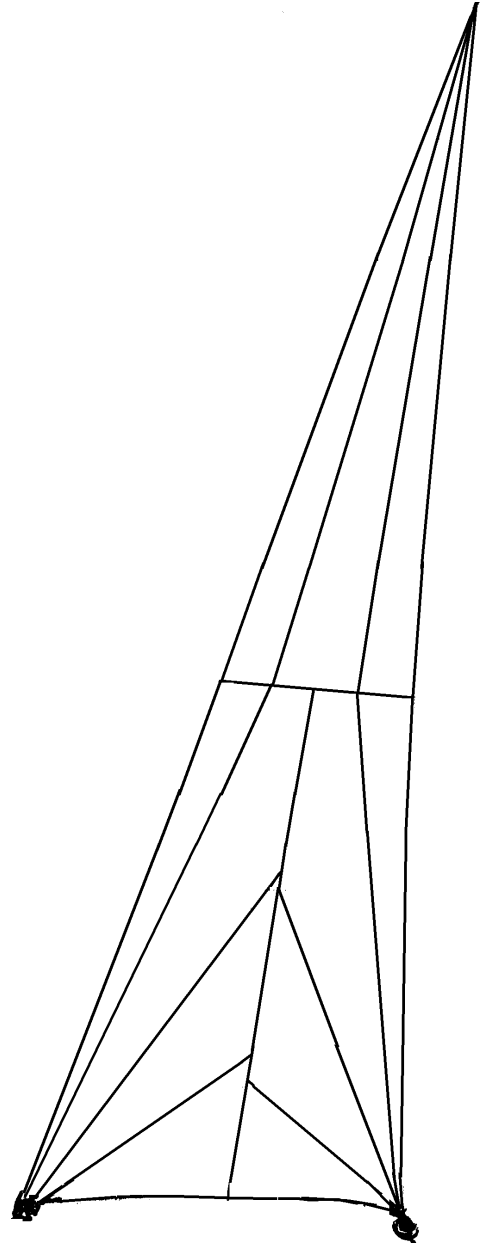

99267450 : Sac spinnaker
Spinnaker bag
Spitasche

18560420 : Sac cordages Spinnaker
Spi rope bag
Spileinetasche

Hobie Cat 18 Pacific Kit de spi/Spi kit 18570310

ss spi - w/o spi - o. Spi

Le kit de spi ne peut fonctionner que
si une bôme est installée
**A boom must be installed before
using the spinnaker kit**

- 1 - 99220057 : Pontet forgé D5
Eye strap
Gusseisenbeschlag
- 2 - 99500114 : Poulie Harken H082
Harken block H082
Block Harken H082
- 3 - 18041721 : Collier de spi
Spi head mast fitting
Mastbeschlag für Spi
- 4 - 18080565 : Bride tangon
Pole bridle
Spibaum-Hanepot
- 5 - 18062635 : Tangon de spi
Spi pole
Spibaum
- 6 - 21060060 : Poulie tête-à-tête H114
Spi block H114
Block spi H114
- 7 - 99500117 : Poulie winch
Ratchet block
Knarr-Block

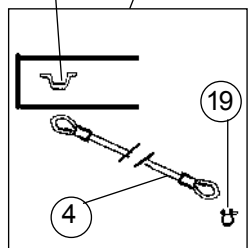
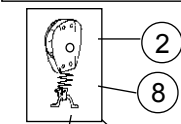
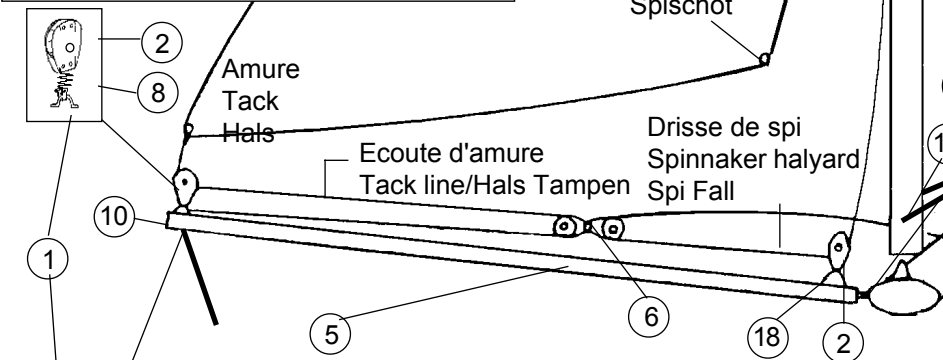
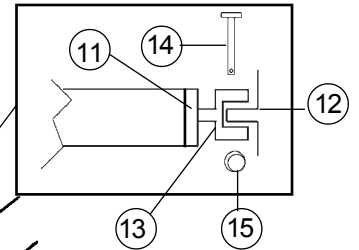
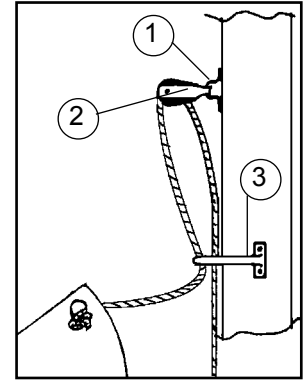

Les Poulies se montent sur les chapes d'articulation de Haubans.
The sheet blocks are mounted at the base of the shroud adjusters.
Blöcke müssen auf den Wanten-Toggle eingestellt werden

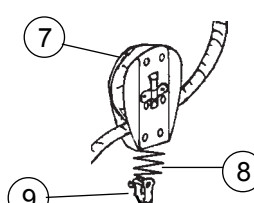
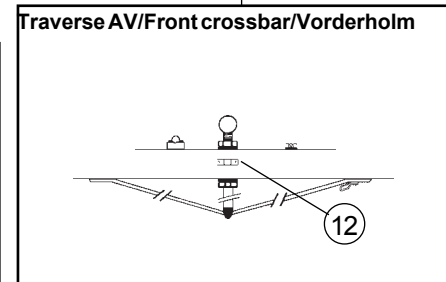



- 8 - 18060142 : Ressort poulie écoute foc/spi
Spi sheet block spring
Spischotblock-Feder
- 9 - 99220035 : Manille lyre 6 mm
99220092 (x20) : Shackles 6 mm
99220093 (x50) : Schâkel 6 mm
- 10 - 21041734 : Embout tangon plast.
Spi pole end cap
Endstück Spibaum
- 11 - 21062625 : Embout tangon plast. percé
Spi pole end cap drilled
Endstück Spibaum gebohrt
- 12 - 16056025 : Articulation tangon
Spi pole connection
Verbindung Spibaum
- 13 - 18061320 : Chape d'articulation tangon
Spi pole connection toggle
Verbindungswirbel Spibaum

- 14 - 14061245 : Axe barre
Connection pin
Bolzen
- 15 - 99220031 : Anneau brisé
99220230 (x10) : Split ring
99220131 (X50) : Splintring
- 16 - 17060302 : Bras de rotation
Rotation arm
Rotationsarm
- 17 - 99220307 : Vis TH 8x110
Screw TH
Schraube
- 18 - 99220215 : Pontet point d'amure
Eye strap
Bügel
- 19 - 99220036 : Manille 4 mm
Shackle 4 mm
Schâkel 4 mm

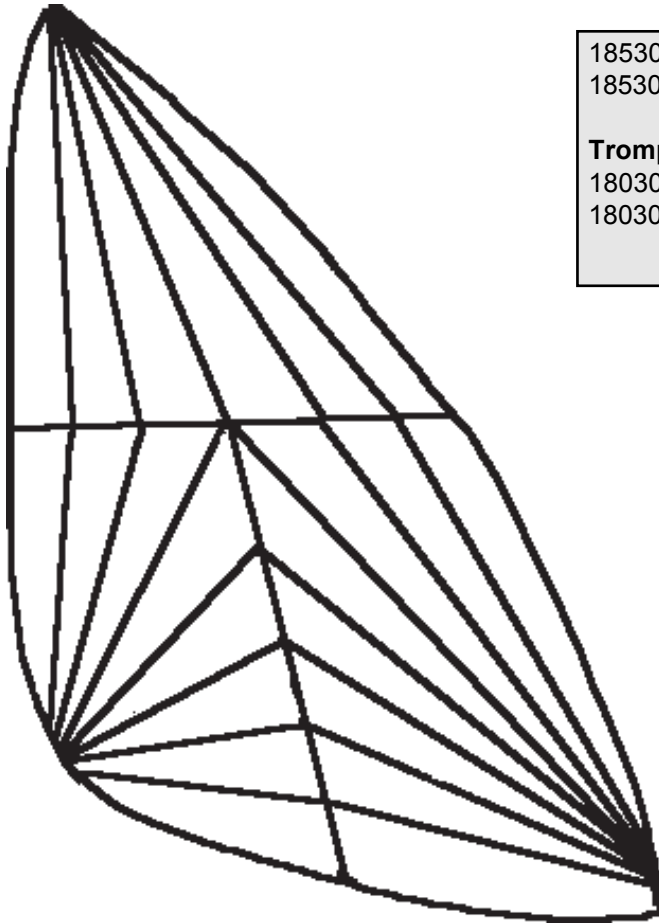

**Hobie Cat 18 Pacific
SPINNAKER**



18530200 : Blanc/white/weiß
18530205 : Couleur/color/farbig

Trompette/Trumpet/Spikanone

18030197 : Blanc/white/weiß
18030198 : Jaune/Yellow/Gelb

Hobie Cat 18 Pacific
Trampoline/Trampoline
(Mesh)

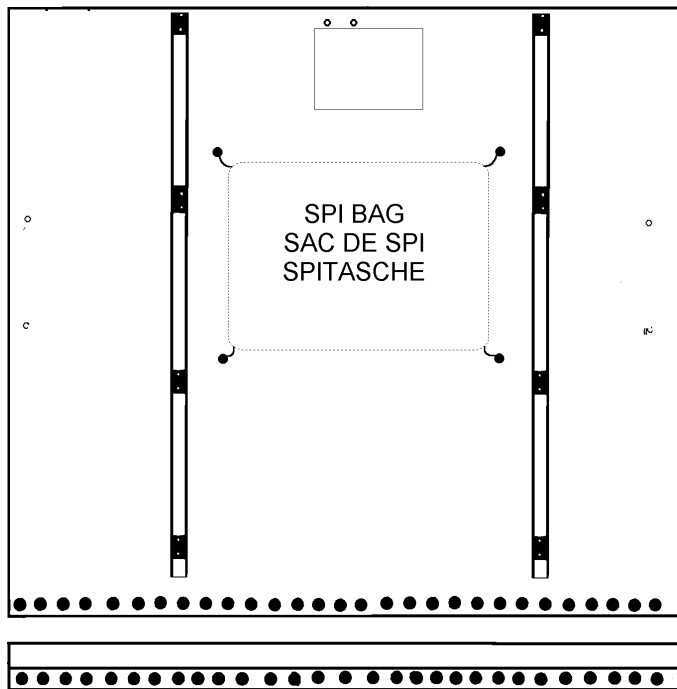

18525800 (2,50 m - 2001)
18025840 (2,60 m - 2001)

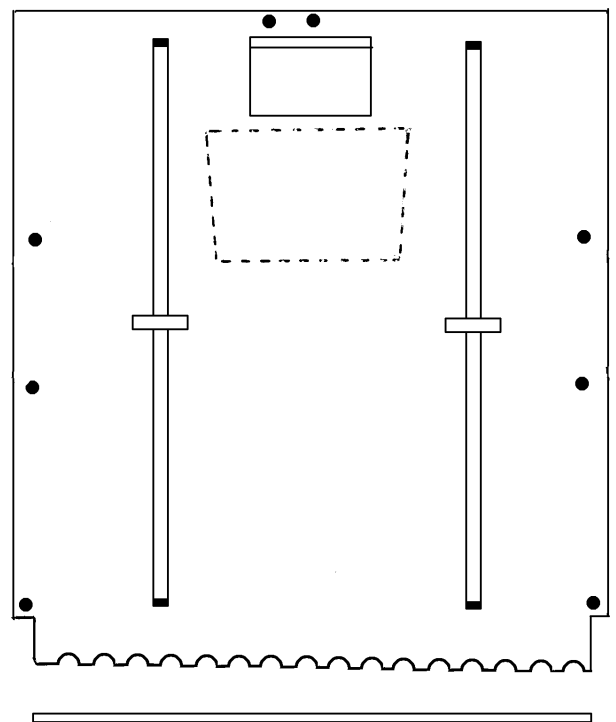

18525850 (2,50 m - 2002)
18025850 (2,60 m - 2002)

18525000 : Jonc Trampoline Pacific (2,50 m)
Fibreglass lacing rod (2,50 m)
18025000 : Jonc trampoline Tiger (2,60 m)
Fibreglass lacing rod (2,50 m)
99267465 : Sac de spi (option)
Spinnaker bag (optional)
Spitasche (mit Aufpreis)

Hobie Cat 18 Pacific
Barber de foc/Jib barber hauler

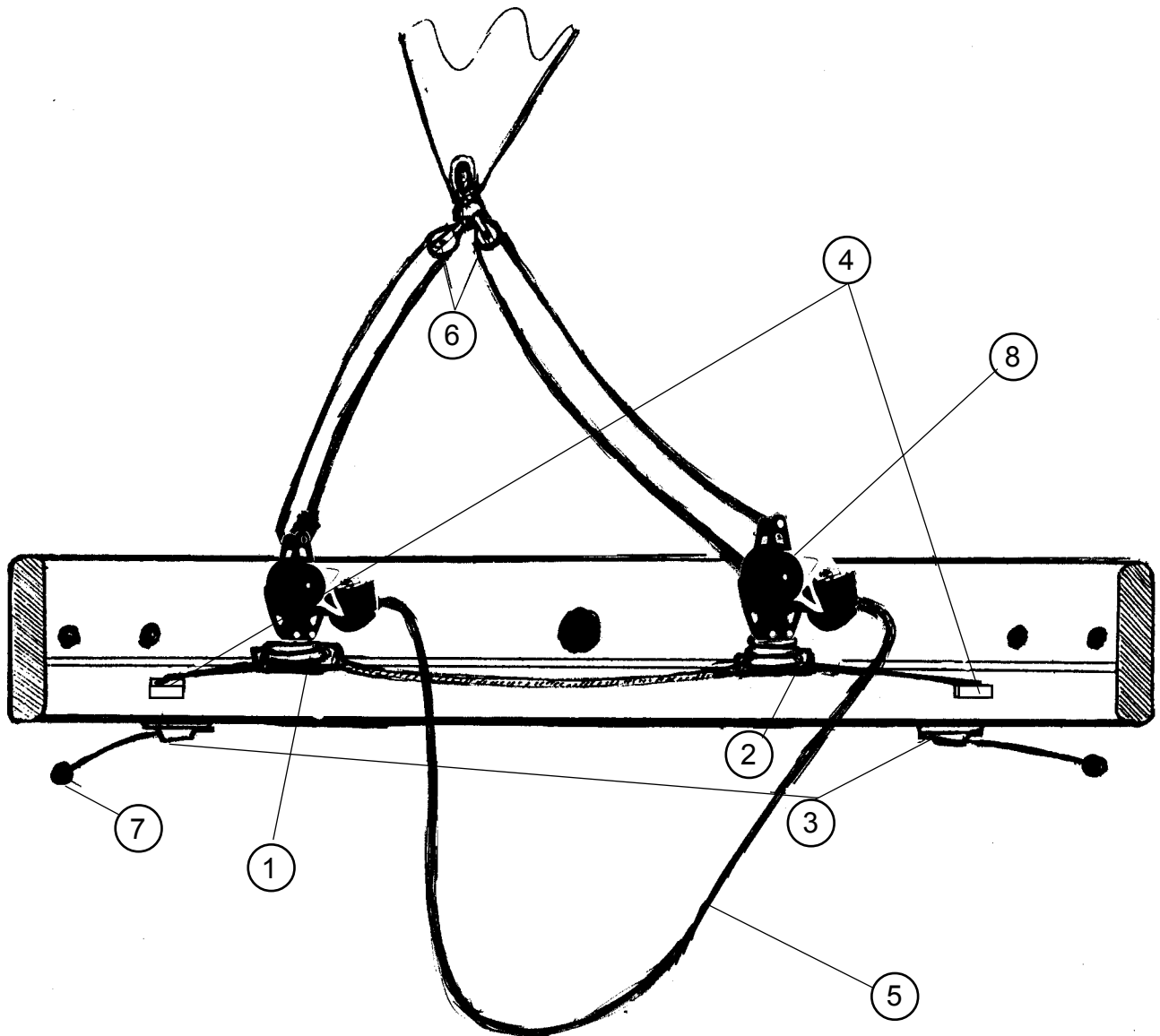

- 1 - 18580055 : glissière Chariot gauche
Jib slideleft
Fockschotschlitten links
- 2 - 18580060 : glissière Chariot droit
Jib slideright
Fockschotschlitten rechts
- 3 - 99500540 : Taquet alu
Clamcleat alu
Klemme Alu
- 4 - 99500545 : Poulie Barber foc
Exit block
Umlenkrolle

- 5 - 16060418 : écoute de foc
Jib sheet
Fockschot
- 6 - 99500114 : Poulie point d'écoute de foc
Jib clew block
Fockschotblock
- 7 - 99500103 : Boule d'arrêt
Stop ball
Plastikkugel
- 8 - 99500800 : Poulie de foc + ressort
Jib block assembly
Block mit Splint

Chariot complet/Complete traveller/
Traveler Komplet = N° 8 + 1/2

Hobie Cat 18 Pacific
 Palan de grand-voile/Mainsheet system
 Großschot-System

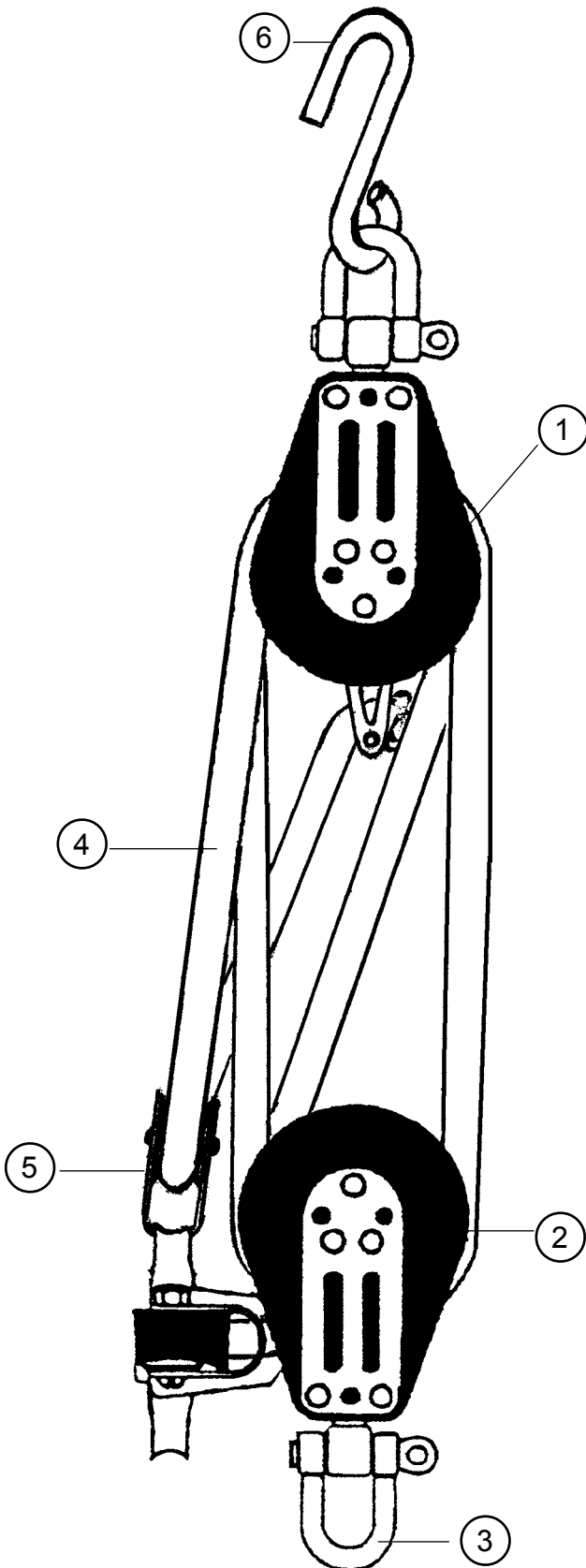

- 1 - 99500367 : Poulie triple ringot
 Threefold block with bequet
 Dreifacher Block
- 2 - 16080370 : Poulie triple winch
 Triple ratchet block
 Dreifacher Block
- 3 - 99220042 : Manille de poulie
 Block shackle
 Blockschäkel
- 4 - 18060419 : Ecoute de grand-voile
 Mainsheet
 Großschot
- 5 - 99500368 : Poulie simple 7ème brin
 Single block
 Einzel Block
- 6 - 99500260 : Crochet de grand-voile
 Hook mainsheet
 Großsegel-Haken

CUNNINGHAM

- 99500115 : : Poulie triple
 Triple block
 Dreifacher Block
- 99500210 : Crochet
 Hook cunningham
 Vorliekstrecker-Haken

Hobie Cat 18 Pacific
BOME/BOOM/BAUM
 18512800



99211010
Pop 4,8 x 11

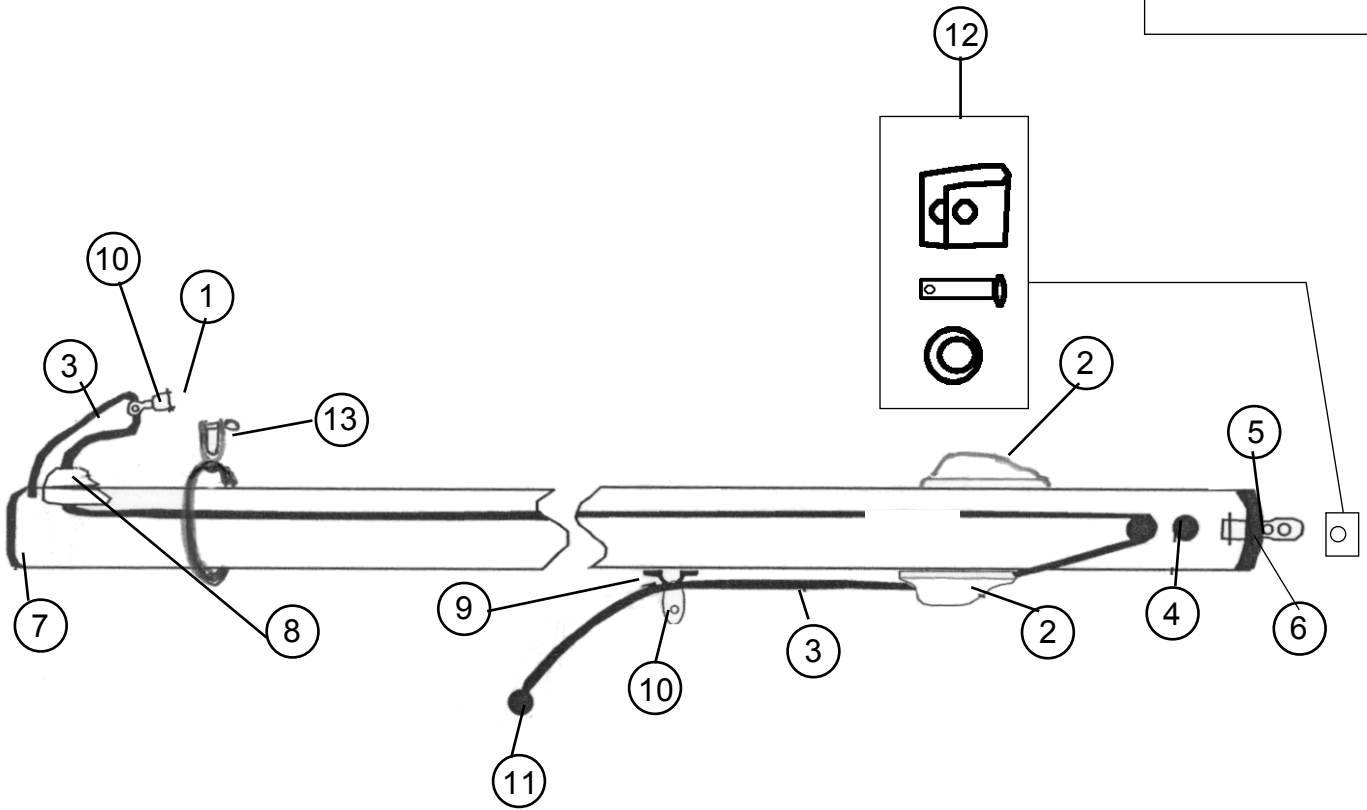

- | | |
|---------------|--|
| 1 - 18042710: | Manille lyre
Shackle
Schäkel |
| 2 - 99500540: | Taquet alu noir
Cam cleat aluminium black
Klemme aluminium schwarz |
| 3 - 18060412: | Cordage D5
D5 rope
Leine D5 |
| 4 - 99500490: | Poulie
Cheek block
Block |
| 5 - 18011870: | Ancrage vit mulet
Gooseneck fastening
Bauteil f. Lümmelbeschlag |
| 6 - 18069000: | Embout de bôme av.
Front boom end cap
Baumendkappe vorne |
| 7 - 99220202: | Embout de bôme arrière.
Boom rear end cap
Baumendkappe hinten |

- | | |
|-----------------|--|
| 8 - 99500545: | Poulie barber
Exit block
Block |
| 9 - 99220057: | Pontet
Eye strap
Bügel |
| 10 - 99500478: | Poulie simple
Simple block
Block Einfach |
| 11 - 99500103: | Boule d'arrêt
Stop ball |
| 12 - 14070352: | Charnière centrale vit mulet
Gooseneck vertex
Gleiter Lümmelbeschlag |
| 13 - 18042712 : | Anneau + manille
Ring + shackle
Ring mit Schäkel |

18062950
gauche
left
links

Hobie PACIFIC
Sport Wing Assembly
Ailes Sport
Sport-Wing

18062955
droit
right
rechts

Assise aile sport
Wing tube sport

18062960 = Gauche/left/links
18062965 = Droite/right/rechts



17562400
Bouchon de trav. AV gauche
Beam cap front left
Vorderholmendstück links



17562405
Bouchon de traverse AV droit
Beam cap front right
Vorderholmendstück rechts

99100001
Tube plymouth
Plymouth tube

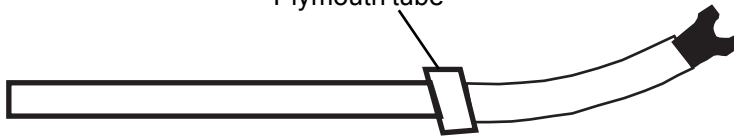

18062930
Bras d'aile sport complet
Wing arm sport complete
Wingarm Sport Komplett

18041733
Casting embout wing
End casting wing

99220142
Vis 6 x 60
Bolt 6 x 60
Bolzen 6 x 60

99216004
Rivet 4.8x19
Pop rivet 4.8x19
Popniete 4.8x19

99216020
Rivet 4,8 x 14
Rivet 4,8 x 14
Popniete 4,8 x 14

99220201
Embout plast. 45 mm
End cap plast. 45 mm
Endstück 45 mm

99220032
Rondelle inox 6 mm
Washer stainless 6 mm
Unt.Scheibe inox 6 mm

99220019
Ecrou indessérable 6 mm
Nylstop nut 6 mm
Selbstsichernde Mutter 6 mm



18062400
Bouchon de trav. AR gauche
Boom cap rear left
Achterholmendstück links



18062405
Bouchon de traverse AR droit
Boom cap rear right
Achterholmendstück rechts

17025810
Embout plast. 48 mm
End cap plast. 48 mm
Endstück 48 mm

20506050
Neoprene
Neoprene
Antirutsch-belag



18562910 : Aile gauche s/s trampoline
Left wing w/o trampoline
Wing links o. Trampoline

18562920 : Aile droite s/s trampoline
Right wing w/o trampoline
Wing rechts o. Trampoline

**OPTION
OPTIONAL**

Hobie Cat 18 Pacific
Kit d'ailes classiques/
Classic wings kit

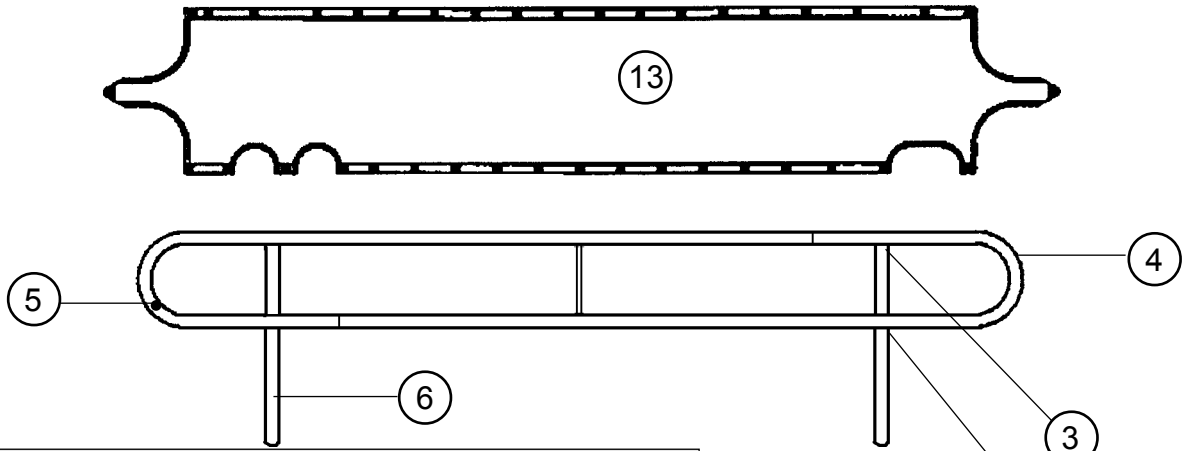

1 - 18562930 : Assise aile complète gauche s/s tramp.
Complete wing sitting area left w/o tramp.
Wing-Sitzfläche kompl. links o. tramp.

18562940 : Assise aile complète droite s/s tramp.
Complete wing sitting area right w/o tramp.
Wing-Sitzfläche kompl. rechts o. tramp.

2 - 21041732 : Casting croix wing
Cross casting wing
Kreuz-Gussecke Wing

3 - 21041733 : Casting embout wing
Wing end casting
Gußeckendstück Wing

4 - 21062930 : Assise aile nue noire
Wing sitting area bare black
Wing-Sitzfläche roh schwarz

5 - 99210048 : Bouchon d'assise
End cap wing sitting area
Endstück Wing-Sitzfläche

99210050 : Rivet bouchon étanche
Rivet cap watertight

99216004 : Pop inox TB 4,8 x 19
Pop rivet ss 4,8 x 19
Popniete 4,8 x 19

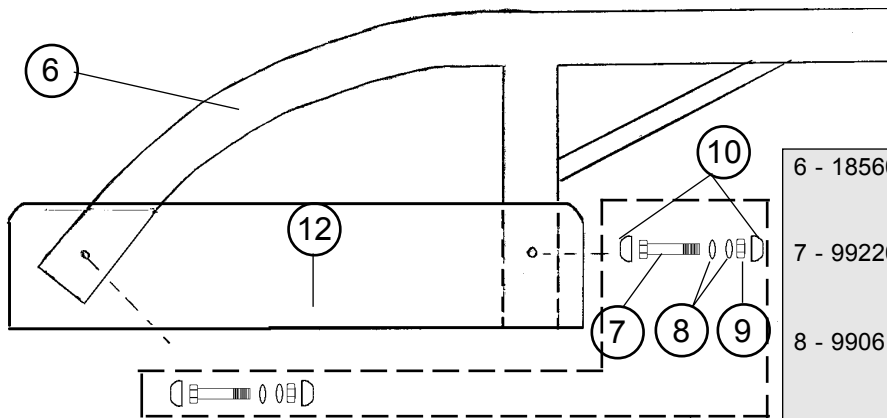

12- 18560360 : Fixation bras d'aile avant
Mounting front wing arm
Wingarm-Befestigung vorne

18560365 : Fixation bras d'aile arrière
Mounting rear wing arm
Wingarm-Befestigung hinten

13- 18025895 : Trampoline d'aile mesh x 2
Wing mesh trampoline x 2
Netztrampoline f. Wing x 2

6 - 18560340 : Bras d'aile complet
Wing arm complete
Wingarm komplett

7 - 99220044 : Vis TH 8x75
Screw TH 8x75
Schraube 8x75

8 - 99061110 : Rondelle D8
Washer D8
Unterlegscheibe D8

9 - 99220012 : Ecrou indessurable D8
Nylstop nut D8
Selbstsichernde Mutter D8

10- 99210045 : Capuchon de vis TH8
Screw cap
Schraube-Endstück

11- 18562970 : Kit montage 2 ailes
(=#7+#8+#9+#10) Mounting kit 2 wings
Aufbausatz für 2 Wings

18062990
Gauche/Left/Links

Hobie Pacific

Ailes confort + Trampoline

Comfort wings + Trampoline

18062995
Droite/Right/Rechts



18062410
Bouchon de traverse AV gauche
Beam cap front left
Vorderholmendstück links

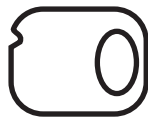

18062415
Bouchon de traverse AV droit
Beam cap front right
Vorderholmendstück rechts

18025900
paire de trampoline droit/gauche
Trampoline set right/left
Trampolinesatz rechts/links

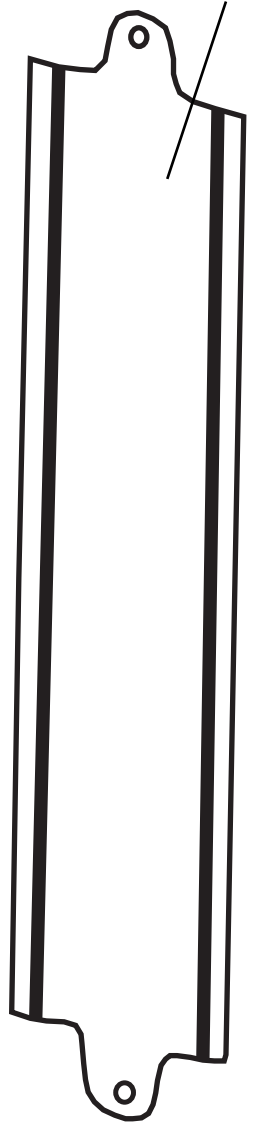

17560355
Bras d'aile confort
Comfort wing arm
Wingarm comfort

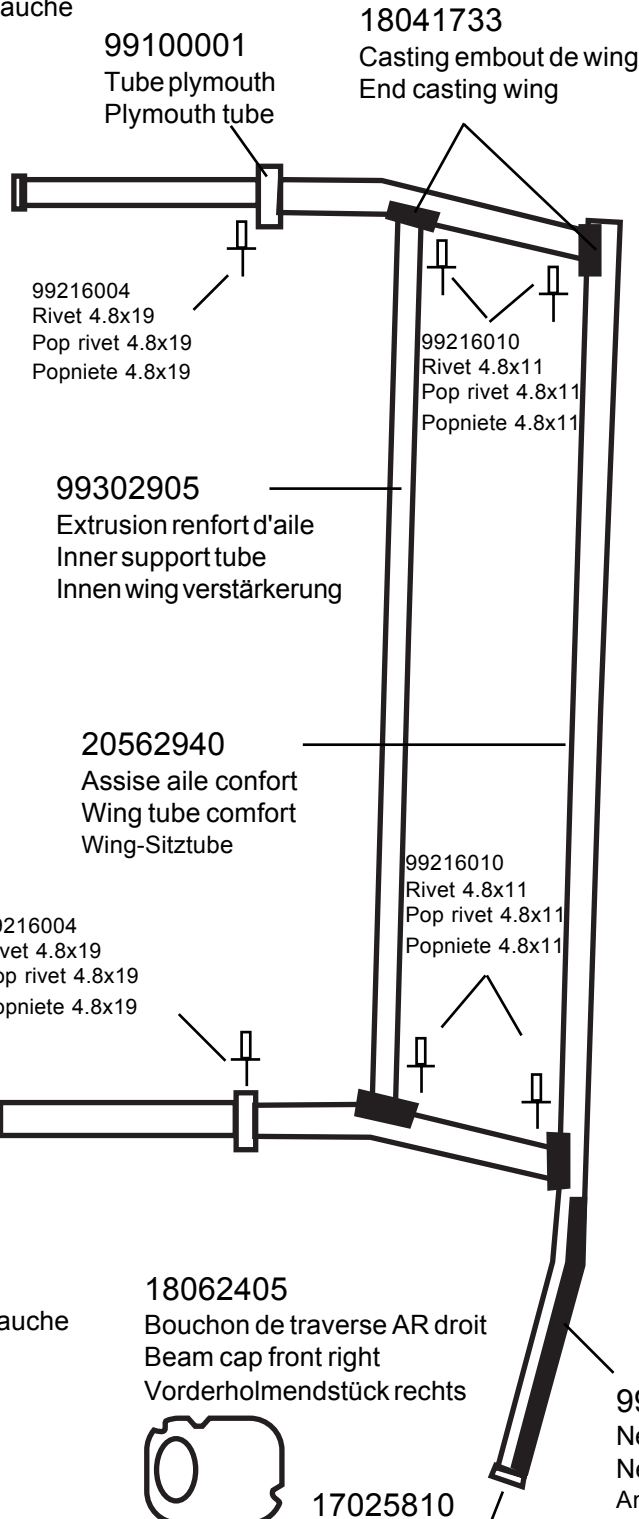

99100001
Tube plymouth
Plymouth tube

18041733
Casting embout de wing
End casting wing

99216004
Rivet 4.8x19
Pop rivet 4.8x19
Popniete 4.8x19

99216010
Rivet 4.8x11
Pop rivet 4.8x11
Popniete 4.8x11

99302905
Extrusion renfort d'aile
Inner support tube
Innen wing verstärkerung

20562940
Assise aile confort
Wing tube comfort
Wing-Sitztube

99216010
Rivet 4.8x11
Pop rivet 4.8x11
Popniete 4.8x11

99216004
Rivet 4.8x19
Pop rivet 4.8x19
Popniete 4.8x19

99220201
Embout plast.
End cap plast.
Endstück

18062400
Bouchon de traverse AR gauche
Beam cap front left
Vorderholmendstück links



18062405
Bouchon de traverse AR droit
Beam cap front right
Vorderholmendstück rechts



17025810
Embout plast.
End cap plast.
Endstück

99506050
Neoprene anti-derapant
Neoprene anti-skid
Antirutsch-Belag

